

TECHNICAL DATA

SCREW-SERT

SCREW-SERT INSERTS & STUDS

INSERTS

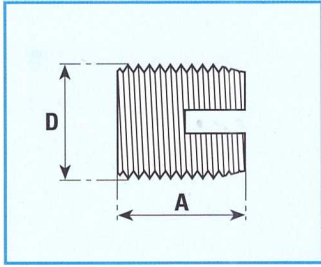

Product Code SCT

HEADED INSERTS

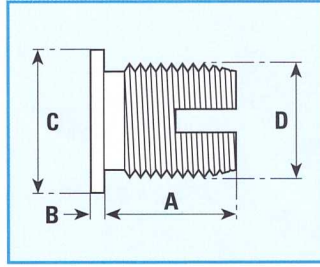

Product Code HSCT

STUDS

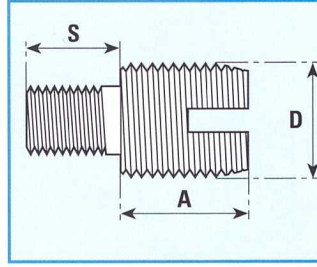

Product Code SCTS

STANDARD MATERIALS - Brass (B) Hardened Steel (S) - Other materials possible on quotation

DIMENSIONS

INTERNAL THREAD SIZES		A	B	C	D	Rec. Hole Size Thermoplastics	Rec. Hole Size Thermosets	Min. Wall Thickness
Unified	ISO Metric	mm	mm	mm	mm	mm	mm	mm
-	2.5	6.0	0.58	6.0	4.5	4.0-4.1	4.1-4.3	Evaluate by pre- production tests
4	3	6.0	0.58	6.5	5.0	4.5-4.6	4.6-4.8	
6	3.5	8.0	0.73	7.5	6.0	5.3-5.4	5.5-5.7	
8	4	8.0	0.89	8.0	6.5	5.8-5.9	6.0-6.2	
10	5	10.0	1.06	9.5	8.0	7.1-7.2	7.3-7.6	
1/4	6	14.0	1.32	12.0	10.0	8.6-8.8	9.0-9.4	
5/16	8	15.0	1.32	14.0	12.0	10.6-10.8	11.0-11.4	
3/8	10	18.0	1.57	16.0	14.0	12.6-12.8	13.0-13.4	
1/2	12	22.0	1.57	18.0	16.0	14.6-14.8	15.0-15.4	

A = Standard lengths
Other lengths possible on quotation.

Standard Stud Lengths (Dimensions 'S')

MILLIMETRES	5	6	8	10	12	14	16	18	20	25
INCHES	3/16	1/4	5/16	3/8	7/16	1/2	5/8	3/4	7/8	1

HOW TO SPECIFY

INSERTS

PRODUCT CODE	SCT-B-M3
MATERIAL	SCT-B-M3
THREAD SIZE	SCT-B-M3

HEADED INSERTS

PRODUCT CODE	HSCT-B-M3
MATERIAL	HSCT-B-M3
THREAD SIZE	HSCT-B-M3

STUDS

PRODUCT CODE	SCTS-B-M4-10mm
MATERIAL	SCTS-B-M4-10mm
THREAD SIZE	SCTS-B-M4-10mm
LENGTH (if applicable)	SCTS-B-M4-10mm