

TECHNICAL DATA

SPIRO

INSERTS

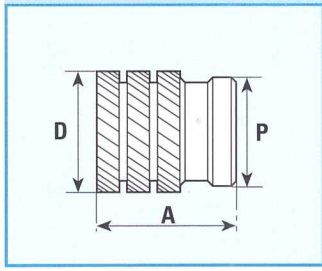

Product Code SP

HEADED INSERTS

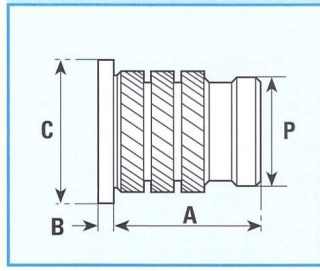

Product Code HSR

STUDS

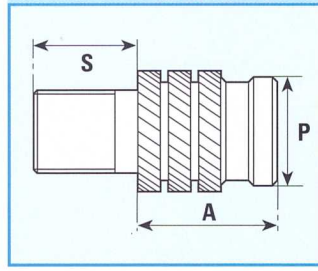

Product Code SPTS

HEADED STUDS

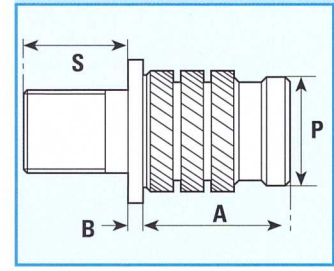

Product Code SPHS

STANDARD MATERIAL - Brass (B) - Other materials possible on quotation

DIMENSIONS

INTERNAL THREAD SIZES		A	B	C	D	P	Rec. Hole Size	Min. Wall Thickness
Unified	ISO Metric	mm	mm	mm	mm	mm	-0.00 +0.10	mm
2	2	4.1	0.51	4.8	3.3	3.0	3.1	1.6
-	2.5	5.3	0.58	5.5	4.2	3.7	3.8	2.0
4	3	5.3	0.58	5.5	4.2	3.7	3.8	2.0
6	3.5	6.3	0.74	6.4	5.0	4.5	4.6	2.5
8	4	7.4	0.89	7.1	5.8	5.3	5.4	2.5
10	5	8.3	1.07	7.9	6.6	6.1	6.2	2.5
1/4	6	9.2	1.32	9.5	8.2	7.7	7.8	2.8
5/16	8	9.2	1.32	11.1	9.7	9.3	9.3	3.8
3/8	10	9.2	1.57	14.0	12.7	12.2	12.3	5.0

A = Standard lengths.
Other lengths possible on quotation.

Standard Stud Lengths (Dimensions 'S')

MILLIMETRES	5	6	8	10	12	14	16	18	20	25
INCHES	3/16	1/4	5/16	3/8	7/16	1/2	5/8	3/4	7/8	1

HOW TO SPECIFY

INSERTS

PRODUCT CODE	SP-B-M3
MATERIAL	SP-B-M3
THREAD SIZE	SP-B-M3

HEADED INSERTS

PRODUCT CODE	HSR-B-M3
MATERIAL	HSR-B-M3
THREAD SIZE	HSR-B-M3

STUDS

PRODUCT CODE	SPTS-B-M4-10mm
MATERIAL	SPTS-B-M4-10mm
THREAD SIZE	SPTS-B-M4-10mm
LENGTH (if applicable)	SPTS-B-M4-10mm

HEADED STUDS

PRODUCT CODE	SPHS-B-M5-12mm
MATERIAL	SPHS-B-M5-12mm
THREAD SIZE	SPHS-B-M5-12mm
LENGTH (if applicable)	SPHS-B-M5-12mm

SPIRO INSERTS & STUDS